

Levant stairlift

User Manual



A ThyssenKrupp
Elevator company

ThyssenKrupp Accessibility



ThyssenKrupp

ATTENTION

READ THIS USER MANUAL CAREFULLY BEFORE USING
THE STAIRLIFT

PAY SPECIAL ATTENTION TO THE CHAPTER 'SAFETY
INSTRUCTIONS'

KEEP THIS MANUAL IN THE VICINITY OF THE STAIRLIFT
SO THAT YOU WILL ALWAYS HAVE THE INFORMATION
YOU NEED AVAILABLE

Table of contents

Preface	3
Safety instructions	6
1. Introduction	9
2. Operation	11
2.1 Operating parts	11
2.1.1 Call and send stations	11
2.1.2 Control unit	12
2.1.3 Main switch	12
2.2 Use of the stairlift	13
2.2.1 Calling the stairlift	13
2.2.2 Unfolding the chair	14
2.2.3 Taking a seat on the chair	15
2.2.4 Driving the stairlift	15
2.2.5 Rising from the chair	16
2.2.6 Folding up the chair	16
2.3 Signals during normal use	16
3. Warning signals	17
3.1 Warning and alarm signals	17
3.2 Examples	18
3.2.1 Self chosen stop	18
3.2.2 Obstacle on the staircase	18
3.2.3 Batteries not sufficiently charged	18



4. Maintenance and service **19**

4.1 Cleaning 19

4.2 Changing the batteries of the call and send station 19

4.3 Preventive maintenance 20

4.4 Technical specifications 21

4.5 Contact 22

Preface

Congratulations!

You have chosen a stairlift produced by ThyssenKrupp Accessibility. A modern, user-friendly and safe product that will give you years of service. We will do everything (in our power) to justify the confidence you have placed in us. To make the best possible use of the stairlift, it is important to read these instructions carefully before first using the Levant.

These instructions

These instructions are meant for you as the user of the Levant stairlift. The instructions contain all necessary information for the correct and safe use of the stairlift.

In the instructions the words “left”, “right”, “front” and “back” are used to indicate a certain part of the stairlift. Here the basic premise is always the position of you as the user, sitting on the stairlift.

Symbols

In this user manual the following symbols will be used:



TIP

Tips for and advice about the correct performance of a procedure.



CAUTION

Risk of damage to (parts of) the stair lift and/or minor physical injury in the event of failure to comply with the instructions in full.



WARNING

Risk of severe physical injury in the event of failure to comply with the instructions in full.

Stairlifts and the environment



Batteries

The stairlift contains two batteries for the supply of the electrical motor, 12 V (7 Ah). These batteries may only be replaced by authorised engineers. The user may replace the batteries in the call and send stations.

Do not deposit old batteries with household wastes but turn them in when you buy the new batteries. If this is not possible, consult your Local Authority to determine the recommended disposal.

Disposing of the stairlift

Stairlifts that are no longer in use are often taken back by your dealer after consultation. If this is not possible, consult your Local Authority to determine the possibility of recycling them or other environmentally friendly ways of processing the materials.

Safety instructions

General

Your Levant stairlift has been designed for maximum user-friendliness in domestic households. To ensure that the stairlift is operated correctly, it is important that every user is aware of the instructions in this user manual. You, as end user of the stairlift, are always completely responsible for compliance with local safety requirements and directives.

ThyssenKrupp Accessibility is therefore not responsible for damage or injury caused by failure to correctly observe the safety requirements and directives as described in the user manual, or improper use during the use or maintenance of the stairlift.

Warning stickers on the stairlift

The warning stickers on the Levant stairlift are an important part of our safety measures. The stickers may therefore not be covered or removed and must always be visible and legible. If the warning stickers are unreadable or damaged, they must be replaced immediately. You can contact your supplier for this.

Users

- Only adults who are aware of the contents of the instructions are permitted to use the stairlift.
- Minors and the mentally handicapped may only use the stairlift under supervision.
- The stairlift is exclusively intended for the transportation of one person per ride.
- Never exceed the maximum capacity allowed (permissible weight: 300 lb).
- Do not use the stairlift to transport animals or goods.
- Never change the sequence of the actions to be performed!

- Keep children away from the stairlift. Do not let them play with the stairlift.

Use

- Before use, inspect both the stairs and the stairlift. Use the stairlift only when the stairs are free from obstruction. Be sure there are no obstacles in or on the rail.
- Practice with the stairlift until you are fully able to execute all procedures.
- Be careful of loosely hanging articles of clothing (shawls, belts, jackets, wide skirts, etc.). Be sure they do not become caught in the moving parts of the stairlift.
- Never stand on the stairlift. Sit on the seat and always use the safety belt.
- Remain seated upright during travel. Do not lean back or forward. Do not make any unnecessary movements.
- During travel keep your hands on the armrests.
- Keep your feet neatly on the footrest. Do not let them protrude outside the footrest.
- Do not fold or unfold any parts of the stairlift violently.
- Report unusual sounds or vibrations immediately to your supplier.
- Protect the stairlift against water or moisture.
- Keep the control units free of dirt and grease.

Technical specifications

The major parts that can be found in chapter 1.2 should not be altered.

Maintenance

- Never do repairs on the stairlift yourself. Changes or replacements of parts of the stairlift are only permitted by ThyssenKrupp Accessibility authorised/trained personnel.
- Only carry out maintenance that is described in these instructions.



WARNING

Never remove the main power supply cable from the wall outlet, or switch off the power since the charging of the batteries will then not occur.

Do not remove any labels that belong to the stairlift.

- For N.America it is required to carry out regular inspections and tests to Standard A18.1.10.
- To comply with these requirements please contact your supplier/installation engineer (see 4.5 for details).

1. Introduction

1.1 General description

The Levant is a custom made stairlift with which you can safely and comfortably use a staircase without any physical exertion. The stairlift can transport one person per ride.

The Levant is driven via an electrical motor that is supplied by means of rechargeable batteries. The charging of the batteries takes place at the stop places (top and bottom of the stairs).

The Levant can be operated in two ways:

- Seated on the stairlift you operate the lift by means of the control unit, situated in one of the armrests.
- If the stairlift is not at the place where you wish to seat yourself in it, you can bring the lift to the desired place via the optional wireless call and send stations. These call and send stations are kept in a holder on the wall, at the top and bottom of the stairs.

To limit loss of space when the stairlift is not in use, the armrests, the seat and the footrest can be folded up.

1.2 Major parts

In figure 1.1 you see a schematic overview of the Levant stairlift. The major parts are indicated with lines.



TIP

Figure 1.1 shows the standard arrangement for a right-handed user with the control unit on the right hand armrest.

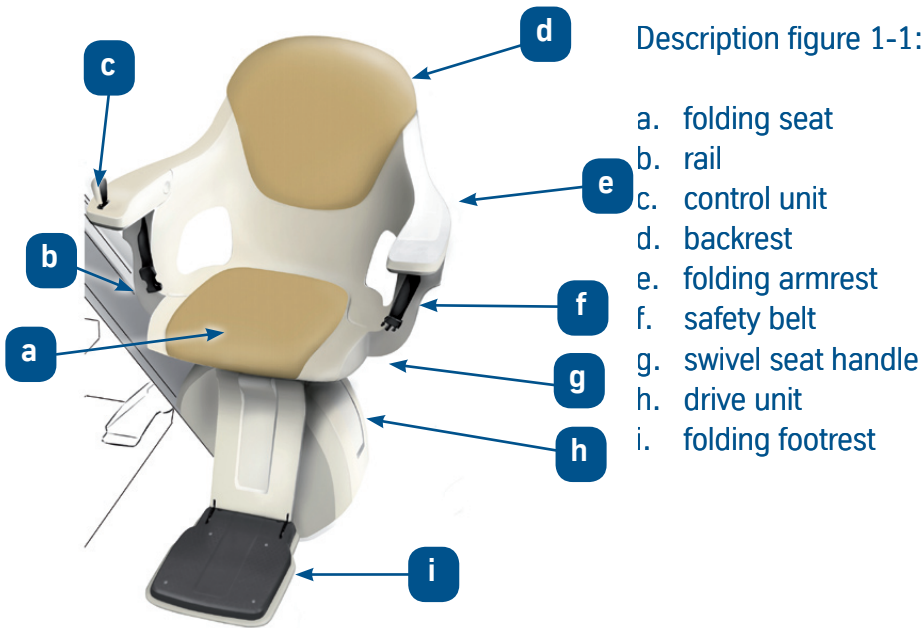

Fig. 1-1: Major parts

2. Operation

This chapter first gives a description of the controls for operation. Then the operation of the lift is described, with all the procedures that occur in daily use.

2.1 Operating parts

The most important controls are:

- The wireless call and send stations.
- The wired control unit in the armrest.



TIP

All buttons on the call and send station and the joystick on the control unit are hold to run. This means that only by holding a button or switch activated will the stairlift move. The lift will make an audible signal prior to any movement (also see chapter 2.3)

2.1.1 Call and send stations

The wireless call and send stations (figure 2-1) are kept in a holder on the wall at the top and bottom of the stairs. With the aid of these stations you can move the stairlift up or down.

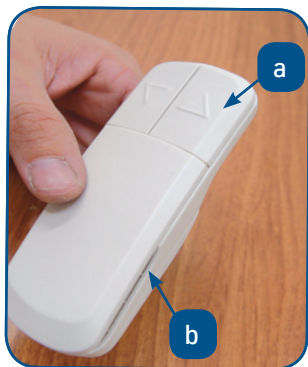

Fig. 2-1: Call and send station

- a. Call and send buttons
- b. Holder



Fig. 2-2: Control unit



TIP

The stairlift will not move if the joystick is not placed in the hole in the control unit.

2.1.2 Control unit

As soon as you insert the joystick in the hole in the control unit, you can, while sitting on the seat, control the stairlift with a single hand movement. The control unit is mounted on the right armrest.

2.1.3 Main switch

With the main switch you can turn the Levant stairlift on and off (for instance when you will go on a holiday, or when you are not at home for a long time).

2.2 Use of the stairlift



CAUTION

Before use read the safety instructions carefully.

2.2.1 Calling the stairlift



TIP

Keep in mind that the buttons on the Call and Send stations are hold to run. As soon as you release the buttons, the stairlift stops.

Before you push the call button, check if the staircase is free from obstacles. Then push the call button of the call and send station (see figure 2-1) and keep it pushed until the stairlift has arrived at the stop place.

2.2.2 Unfolding the chair

The stairlift is available at the stop place in a folded position (figure 2-3). You can unfold the stairlift as follows:

- Fold down the footrest (a).
- Fold down the seat (b).
- Fold down the two armrests (c).

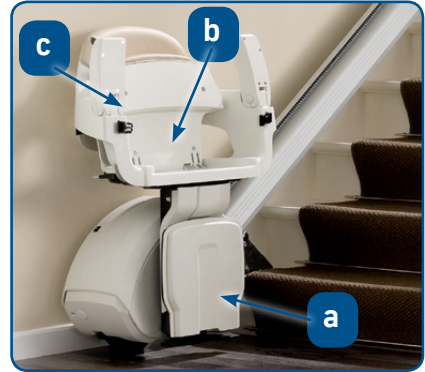

Fig. 2-3: Folded stairlift



CAUTION

The swivel seat of the Levant can only be swivelled upstairs



TIP

The chair can only be turned to one side. When the chair has been turned, the stairlift is electrically disabled. This means that you cannot drive the lift up or down until the chair is not swivelled back in its initial position by pushing the turning handle downwards shortly.



TIP

The swivel of the Levant can make the chair turn for 70 degrees. When you pull the handle upwards you can turn the chair towards the desired position.

2.2.3 Taking a seat on the chair

To easily and safely be seated, you can turn the chair in the desired direction.

1. Unlock the chair by pushing the swivel handle (see figure 2-3) downwards (only upstairs).
2. The chair can now be turned in the desired direction for taking a seat.
3. Sit down on the chair, with your back against the backrest.
4. If you have swivelled the chair, put the chair back to its initial position with the aid of the swivel handle, or the chair will not move.
5. Put your feet neatly side by side on the footrest
6. Close the safety belt for your own safety.

2.2.4 Driving the stairlift

1. Check if the staircase is free from obstacles.
2. Push the joystick on the control unit left or right to send the stairlift up or down.

**TIP**

The joystick on the control unit is hold to run. The stairlift continues driving until you release the joystick or until you have arrived at the end of the ride.

**TIP**

A built-in safety feature makes sure that you cannot switch over from one direction of driving to another direction too quickly. Also after a stop, for example halfway up the stairs, the lift starts after a short delay.



CAUTION

Always park your stairlift on a charging contact. If you do not park the stairlift on a charging contact, the batteries will become empty and you will not be able to use the stairlift.

2.2.5 Rising from the chair

To easily and safely rise from the chair, you can turn the chair in the desired rising direction. Unlock the chair by pulling the swivel handle upwards.

- 1. Open the safety belt.
- 2. Rise out of the chair.

2.2.6 Folding up the chair

If you have swivelled the chair, put the chair back to its initial position with the aid of the swivel handle (only upstairs).

- 1. Fold up the two armrests.
- 2. Fold up the seat.
- 3. Fold up the footrest.

2.3 Signals during normal use

Signal	Meaning
A short beep.	The stairlift is driving away. Or the call and send station is activated.
Two short beeps.	The stairlift reached the end stop and is on a charging contact.

3. Warning signals

Failures may occur. If the stairlift does not work (properly), and you can not solve the problem with this user manual, then call in the help of your supplier. (see chapter 4.5).



CAUTION

Never try to repair the stairlift yourself.

3.1 Warning and alarm signals

Signal	Meaning	Solution
Fast beeps that repeat themselves after every ten seconds.	The stairlift is not on a charging contact, or the power supply is disconnected.	Drive the stairlift to a charging contact.
Fast beeps that continuously repeats itself.	<ul style="list-style-type: none"> - The stairlift has encountered an obstruction and stopped. - The seat is not positioned correctly - There is a malfunction in the stairlift. 	<ul style="list-style-type: none"> - Drive away from the obstacle and remove it. - Turn the seat in its driving position. - Contact your supplier.

3.2 Examples

3.2.1 Self chosen stop

If you wish to stop the stairlift during the trip, for example because you wish to return or because you see an obstacle on the staircase, do the following:

1. Release the joystick on the control unit. The stairlift will stop immediately.
2. Remove the obstacle
3. Push the joystick in the desired direction to continue the ride. If you wish to return, push the joystick in the opposite direction

3.2.2 Obstacle on the staircase

If an obstacle on the staircase, or a body part, becomes caught between a step and the footrest, the stairlift stops automatically and immediately. You will hear fast short alarm beeps.

1. Push the joystick on the control unit in the opposite direction. This way you can drive away from the obstacle.
2. Remove the obstacle.
3. Return in the original direction of travel.

3.2.3 Batteries not sufficiently charged

If the batteries do not have sufficient capacity, you are not able to drive with the stairlift.

In the event of the stairlift stopping while driving upstairs, there is always the possibility to drive downstairs.

4. Maintenance and service

4.1 Cleaning

- Clean the chair of the Levant regularly with a soft, damp cloth and possibly a mild detergent.
- Dust particles can be removed using the vacuum cleaner.
- The rails should regularly be wiped lightly. Be careful not to touch the roller rack.



CAUTION

Do not use caustic detergents and do not use too much water.

4.2 Changing the batteries of the call and send station

In the call and send stations there are two penlight (AA) batteries. When the batteries are empty, you have to replace the batteries (figure 4.1).

1. Open the call and send battery cover
2. Replace the old batteries with the new ones, take care of battery polarity
3. Fit the call and send battery cover
4. Dispose the old battery's to an appropriate waste collecting station



Fig. 4-1: Changing the batteries of the call and send stations.

4.3 Preventive maintenance

In addition to cleaning the stairlift, regular maintenance is needed to guarantee that your stairlift will keep working properly. This maintenance should be carried out by authorized maintenance technicians. We therefore advise you to take out a maintenance contract to ensure that your stairlift will stay in optimal condition. Contact your supplier for more information about the maintenance contract.

For N.America the reLevant sections of the standard A18.1-10 must be used for regular inspections and test.



TIP
Change the batteries annually.



CAUTION
Do not throw the old batteries in the household waste, but treat them as Small Chemical Waste.

4.4 Technical specifications

General	
Europe	
Design weight (max.)	127 - 138 kg (from 53° to 45°)
Driving speed (max.)	0.10 meters per second
Sound	< 65 dB (A)
North America	
Design weight (max.)	300 Lb (max 45°)
Driving speed	20 Ft/min
Electrical system	
Operating voltages	24 V DC rechargeable batteries
Mains (Europe)	240 V 50 Hz
(N.America)	120 V 60 Hz
Environmental conditions	
Environmental temperature	5 - 40 °C
Relative humidity	20 - 80%

4.5 Contact

For information about settings, maintenance or other matters that are not addressed in these instructions, you can contact your local contact.

Local contact:

Name

Address

Tel

.....

.....

.....

LIMITED WARRANTY

Limited Warranty: Subject to the limitations set forth below, THYSSENKRUPP ACCESS MANUFACTURING LLC, 4001 East 138th Street, Grandview, Missouri 64030, warrants to the ORIGINAL PURCHASER ONLY that the Levant stair lift (the "Lift") drive train parts used in the Lift shall be free of defects in material and workmanship for a **five year period** and other component parts used in the Lift shall be free of all defects and workmanship for a **two year period** commencing on the date of purchase. The self-addressed Limited Warranty card must be completed and returned to THYSSENKRUPP ACCESS MANUFACTURING LLC within 30 days from the date of purchase in order for this Limited Warranty to be activated. IF THE LIMITED WARRANTY CARD PROVIDED BY THE DEALER IS NOT RETURNED WITHIN THE FOREGOING TIME PERIOD, THIS LIMITED WARRANTY WILL BE NULL AND VOID.

Warranty Limitations: THE FOREGOING LIMITED WARRANTY IS THE SOLE AND EXCLUSIVE WARRANTY PROVIDED BY THYSSENKRUPP ACCESS MANUFACTURING LLC, AND IS IN LIEU OF ALL OTHER WARRANTIES, WRITTEN OR ORAL, EXPRESS OR IMPLIED, ARISING BY OPERATION OF LAW OR OTHERWISE, BY THYSSENKRUPP ACCESS MANUFACTURING LLC OR ANY OTHER PARTY, INCLUDING, BUT NOT LIMITED TO, WARRANTIES OF MERCHANTABILITY AND FITNESS FOR A PARTICULAR PURPOSE, WHETHER OR NOT THE PURPOSE HAS BEEN DISCLOSED AND WHETHER OR NOT THE LIFT HAS BEEN SPECIFICALLY DESIGNED OR MANUFACTURED FOR BUYER'S USE OR PURPOSE. No person has been authorized to provide any other warranty or to assume any other liability with respect to the Lift except by written statement from an authorized officer of THYSSENKRUPP ACCESS MANUFACTURING LLC. This Limited Warranty does not extend to any losses or damages incurred as a result of any of the following: misuse, neglect, accident, abuse, user's negligence, improper operation (operation not in accordance with Owner's Manual), fire, flood, acts of God, ordinary wear and tear, and damage during shipment, improper assembly, care or maintenance if performed by any individual other than an authorized Dealer of THYSSENKRUPP ACCESS MANUFACTURING LLC. The remedies provided under this Limited Warranty do not extend to minor mechanical adjustments (such as tightening of nuts, bolts and screws).

Limitation of Liability: UNDER NO CIRCUMSTANCES SHALL THYSSENKRUPP ACCESS MANUFACTURING LLC OR ANY OF ITS AUTHORIZED DEALERS BE LIABLE FOR LOSSES OR DAMAGES ARISING FROM DELAY IN PERFORMANCE, OR USE OR INABILITY TO USE THE LIFT, REGARDLESS OF THE FORM OF THE CLAIM OR CAUSE OF ACTION (WHETHER BASED IN CONTRACT, INFRINGEMENT, NEGLIGENCE, STRICT LIABILITY, OTHER TORT OR OTHERWISE), AND IN NO EVENT SHALL THYSSENKRUPP ACCESS MANUFACTURING LLC' LIABILITY TO BUYER EXCEED THE PRICE PAID BY BUYER FOR THE LIFT. BUYER AGREES THAT IN NO EVENT SHALL SELLER'S LIABILITY TO BUYER EXTEND TO INCLUDE INCIDENTAL, CONSEQUENTIAL, SPECIAL OR PUNITIVE DAMAGES. The term "consequential damages" shall include, but not be limited to, loss of use and loss or damage to property. Some states do not allow limitations on how long an implied warranty lasts or the exclusion or limitation of incidental or consequential damages, or legal remedies, so these above limitations may not apply to you.

Claims: THE SOLE AND EXCLUSIVE REMEDY FOR BREACH OF THE LIMITED WARRANTY HEREUNDER SHALL BE LIMITED TO REPAIR OF THE DEFECT OR REPLACEMENT OF THE LIFT WITHOUT CHARGE. Claims for defects in material and workmanship under this Limited Warranty must be made within the warranty period set forth above by written notification to the authorized THYSSENKRUPP ACCESS MANUFACTURING LLC Dealer from which the Lift was purchased. The written notice must include a description of the defect complained of, along with a copy of the invoice or other proof of purchase and the serial number of the Lift. The authorized Dealer will notify THYSSENKRUPP ACCESS MANUFACTURING LLC of the claim, and either the Dealer or an authorized THYSSENKRUPP ACCESS MANUFACTURING LLC technician will, at THYSSENKRUPP ACCESS MANUFACTURING LLC' option, repair or replace the Lift at Buyer's premises without charge for materials. Buyer may engage a third party other than THYSSENKRUPP ACCESS MANUFACTURING LLC or an authorized THYSSENKRUPP ACCESS MANUFACTURING LLC Dealer or technician to repair or replace the Lift or to cure any defects in material and workmanship that would otherwise be covered under this Limited Warranty. HOWEVER, THIS LIMITED WARRANTY DOES NOT COVER ANY CHARGES OR EXPENSES ASSESSED BY ANY SUCH THIRD PARTY OR COMPANY PERFORMING SUCH REPAIRS OR REPLACEMENT WORK. COSTS FOR PARTS THAT ARE NOT GENUINE THYSSENKRUPP ACCESS MANUFACTURING LLC PARTS, AND/OR DAMAGES TO THE LIFT CAUSED BY THE USE OF NON-GENUINE THYSSENKRUPP ACCESS MANUFACTURING LLC PARTS OR BY THE PERFORMANCE OF A NON-THYSSENKRUPP DEALER OR AUTHORIZED TECHNICIAN, ARE NOT COVERED UNDER THIS LIMITED WARRANTY.

This Limited Warranty gives you specific legal rights, and you may have other rights which vary from state to state.

THYSSENKRUPP ACCESS MANUFACTURING LLC • 4001 East 138th Street • Grandview, MO 64030
www.tkaccess.com